

Solar Panel Track Blind

INSTALLATION INSTRUCTIONS

Tools Required:

Tape measure, pencil, drill, drill bits, screw driver, step stool.

Note: use a 5/64" drill bit to pre-drill the screw holes (for attachment to a wall stud or headerboard). Use a 1/4" drill bit for plastic anchors (for hollow dry wall or plaster mounting).

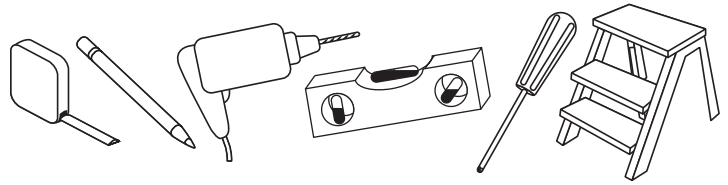

Step 1: Assemble the Head Rail

Attach the head rail sections using the joiner plates as illustrated. The "front" of each head rail section has fabric attached to it.

Step 2: Bracket Location and Installation

This blind is recommended for outside mounting (i.e. outside of the window opening).

A mounting bracket should be positioned about 1" to 4" from each end of the head rail. The other brackets should be spaced evenly between the two outermost brackets. Brackets must be positioned at precisely the same height. Use a steel tape measure to assure accuracy. For floor length blinds add at least 1/2" to the ordered length, and then, using this dimension, make two or more pencil marks above the floor or carpet (for 1/2" clearance). For window length blinds, determine the position for the bottom of the panels, and then position the brackets above this point using the procedure described below. Attach the clips to the brackets as illustrated using the nuts and bolts. Position the clips in the center of the bracket slots (this can be adjusted later as desired).

Attach the clips and brackets to the head rail as described below (see Step 3). Hold the rail level using the pencil marks for alignment. Mark the exact location for each bracket with the pencil. Remove the brackets from the head rail and position the top of each bracket at the marked location and screw each bracket into the wall or window molding using the 1" screws or screws and anchors.

For Inside Mounts use clips only (brackets not required) – attach the clips to the top of the window opening (one screw per clip).

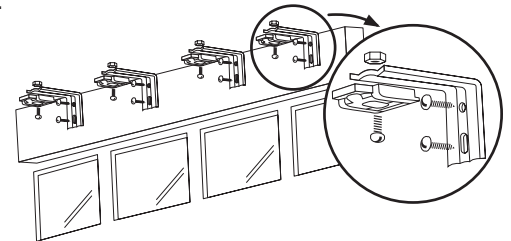
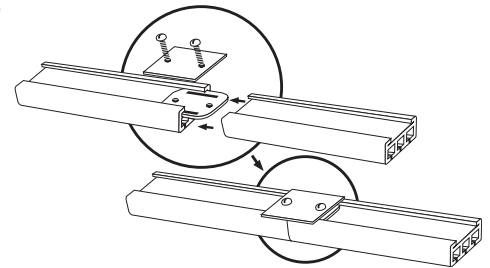

Step 3: Securing the Head Rail

The head rail snaps into the adjustable clips attached to the mounting brackets. (See illustration) Lift the head rail into position such that the back of the channel on top of the head rail fits onto the back of each clip. Then push the rail upward so that the front of each channel engages the tab at the front of each clip. Check carefully to assure that each clip is properly secured.

Step 4: Install the Traverse Wand

Attach the wand to the first track in the head rail.

Step 5: Attach the Panels

Move the wand fully to the left/right side of the head rail so that all tracks are accessible.

Starting with the track at the back of the head rail, attach each panel to a track by pressing the Velcro strips on the panel against the corresponding strips on the tracks.

Slide a hem bar into the hem pocket at the bottom of each panel. Do this slowly to avoid snagging.

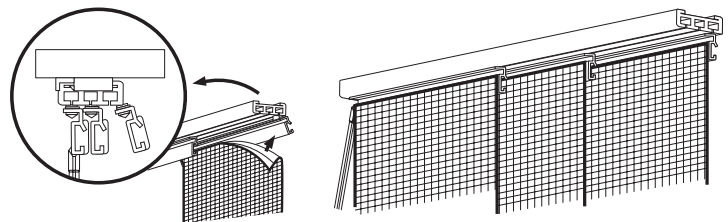

Cleaning

Dusting: Vacuum using the soft brush attachment.

Washing: Use a cloth, sponge or soft brush and a mild detergent. Use warm or cold water, not hot water. Place toweling on the floor or window sill and wash the blind in sections.

REPLACEMENT PARTS

In the event that replacement parts are ever needed, you may call: 1-800-264-1190
Please be sure to provide the following information, if possible:

- The complete model or catalog number of your product
- A description of the product
- A description of the part needed

Solar
Panel
Track
Blind