

## Instructions: RollEase WCMA - ANSI 6.5 Compliant Tension Device

### 1. INSTALL CONTINUOUS CORD OR BEAD CHAIN

Press the center round button on the tension device which exposes the pulley on the opposite side. Hold the tension device by the outside cover. Bend the cord sharply against the first pulley tooth or with bead chain press a single bead in the round opening on the pulley. Push or pull the cord enough to move the pulley. Use the cord as a handle to pull the pulley all the way around until the cord or chain is completely engaged and out of the pulley.

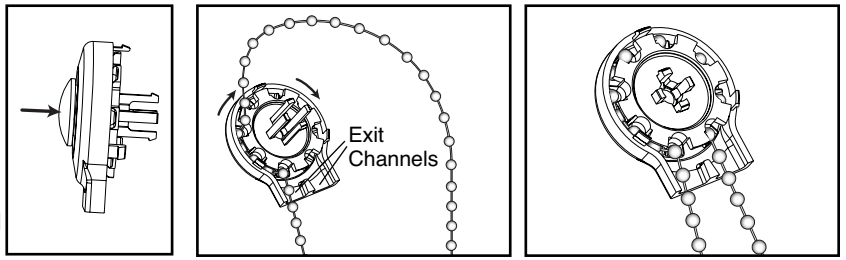

Release the center post which will lock and trap the cord/bead chain. Be sure the control cord/chain exits the channels at the narrow end as shown.

### 2. SNAP TOGETHER

Align front assembly and back cover and snap together. Make sure cord/chain exits channels and is not pinched by the two mating parts. Pull on cord/chain to test that the cord/bead chain does not move and is locked.

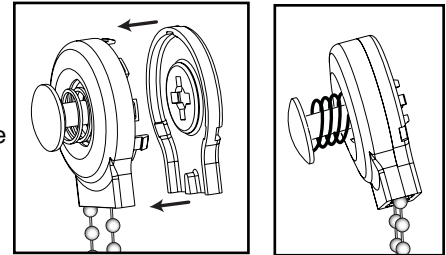

### 3. MATE WITH MOUNTING BRACKET

Choose either the bottom mounting bracket stand (T-shaped) or the side mounting bracket stand (L-shaped). Determine which direction the mounting bracket will face relative to the tension device. Make sure the tension device is snapped into the mounting stand in the same correct direction. Once it is snapped together it is designed not to be removed. On inside mount shades the tension device may be mounted to the window sill, or side window frame or when the treatment spans beyond the window frame it may be mounted to the wall. Press center round button exposing the four latching legs and press into the corresponding thru hole of the mounting bracket stand until they latch snap and lock to the mounting stand.

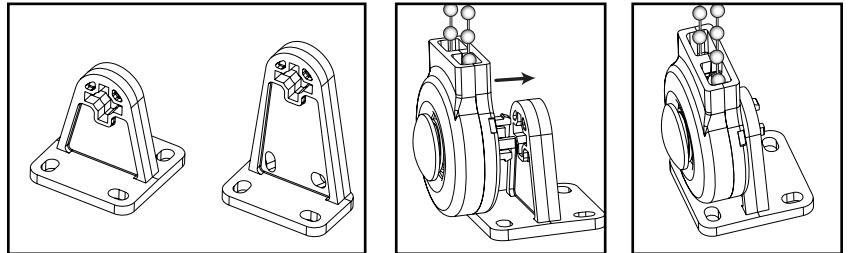

Fit the #10 flat-head screw (provided) into the center and turn clockwise to set screw into position in the center of the four matching legs. Turn screw until screw head touches the four protruding arms which is approximately 5 to 6 complete 360° turns of the screwdriver. Cord/chain should now move freely through the pulley.

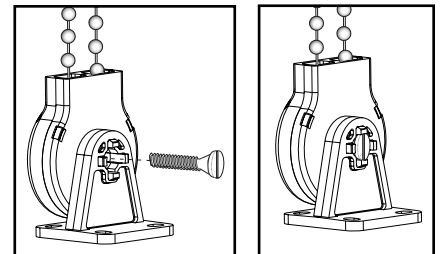

### 4. MOUNT IN WINDOW

Position the Tension Device on the window frame or the wall so that the Tension Device and control cord/chain does not interfere with raising or lowering the shade. **The Tension Device should be installed so that cord/bead chain is taut without stretching or pulling down on it. Stretching the cord/bead chain will cause excessive wear. Do not twist or cross the control cord/bead chain.**

Holding the Tension Device upright, and in position, as shown, insert and secure the two screws through the two holes. **The mounting screws must be secured into a solid surface or molly.**

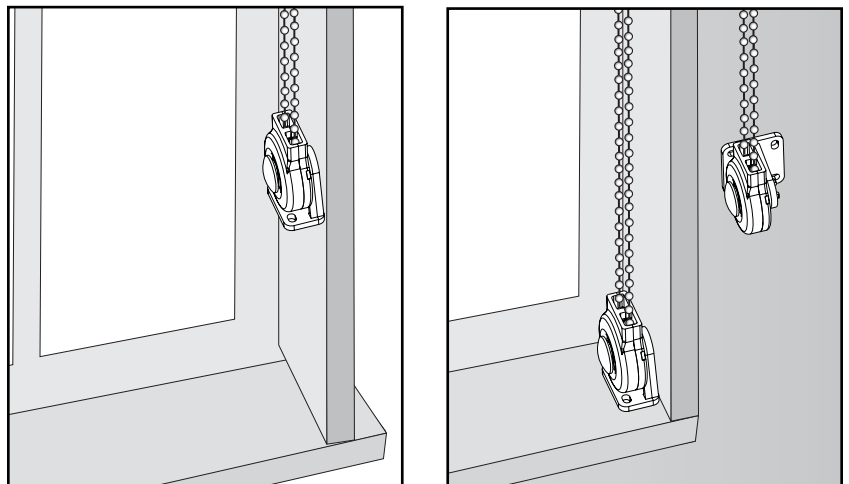

## UNDERSTANDING THE SPEC

The Window Covering Manufacturers Association, Inc. (WCMA) has finalized a revision to the **American National Standards for Safety of Corded Window Covering Products**.

The standard was developed by the WCMA through a consensus standard development process approved by the American National Standards Institute (ANSI). This process brings together volunteers representing varied viewpoints and interests to achieve consensus around window covering products and safety issues. RollEase, Inc. participates on the volunteer panel.

RollEase recommends that if choosing not to follow this revised standard, legal counsel be sought.

### 6.5 Tension Devices

Tension devices for cord or bead loops shall adhere to the following:

#### 6.5.1

**The tension device shall be designed so when not installed will, at least partially, prevent the lift system from moving the window covering through deployment or retraction.**

*RollEase Tension Device: By gripping onto the continuous cord or bead chain in a fixed position, the subassembly prevents full deployment of the shade as it comes into contact with the clutch.*

#### 6.5.2

**A significant portion of the tension device shall be attached to the cord or bead loop upon receipt by the end user.**

*RollEase Tension Device: The subassembly is to be fastened onto the continuous cord or bead chain by the fabricator.*

#### 6.5.3

**The tension device shall be constructed so that it shall only be detached from the cord or bead loop with a sequential process or tools.**

*RollEase Tension Device: The subassembly has four independent tangs which need to be disengaged in unison to disassemble the tension device. The subassembly must be assembled to the mounting bracket to allow the continuous loop to freely pass through the tension device.*

#### 6.5.4

**The tension device shall allow for installation to a surface. Fasteners for surface installation shall be provided with the product. Clear and accurate installation instructions shall be provided to describe proper installation. Once the tension device is installed, it shall perform as a passive device.**

*RollEase Tension Device: The tension device has two options currently for mounting to a sill or wall. When the subassembly is attached to the mounting stand, the continuous loop is fully captured yet free to operate unrestricted. Mounting screws will be provided with the tension device.*

#### 6.5.5

**The tension device shall be designed so that when it is installed according to the installation instructions, it will hold the cord or bead loop taut and close to the product or mounting surface in a manner that makes the tension device's position fixed and immobile, resulting in it being less accessible for young children so as to prevent the operating cord from forming a free-standing loop of more than 6" (152 mm) in length [12 inch (305 mm) circumference].**

*RollEase Tension Device: Installation manual will include the above directive.*

*The above italicized is a comment regarding the offering from RollEase. The RollEase Locking Tension Device functions with continuous cord loop or bead chain. It is available with two options on the mounting stand.*

